



# HO Structure Kit

## NORTHERN LIGHT & POWER

933-3021

Thanks for purchasing this Cornerstone kit. All parts are made of styrene plastic, so use compatible paint and glue. Please read these instructions and study the drawings before starting construction.

This building is right at home in a big city or small town from the 1880s to the present, and is one of a series of Walthers kits you can use to model the electrical industry. The finished model can be used with a large industrial complex, an interurban or streetcar line, or to represent a small area of modern facility. Its large windows invite interior detailing, easily modeled with the Northern Light & Power interior kit (933-3130), which includes boiler, turbine and generator details. For those desiring a more detailed interior, the Cornerstone Series® Overhead Traveling Crane (933-3102) can be adapted to fit inside this building. The Powerhouse kit also includes a track-mounted dump pit for coal deliveries.

For additional details and accessories to add the finishing touch to your model, visit your local hobby shop, see the current HO Model Railroad Reference Book or visit us online at [walthers.com](http://walthers.com).

1. Glue Window Frames and Doors (6, 7, 29, 30, 31, 32) to Walls (2, 3). Glue appropriate Window Glass (8, 9, 10, 11, 11A) as shown.

2. Glue Window Frames (33, 34) to Side Walls (4). Glue appropriate Window Glass (12, 13) as shown.

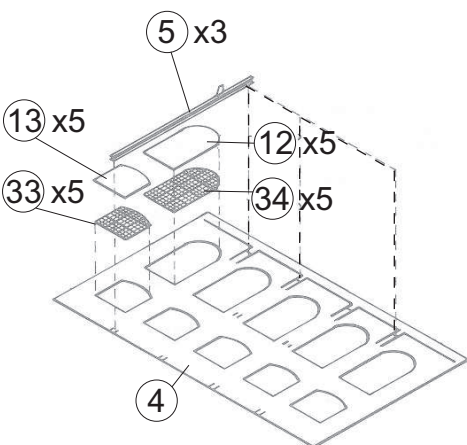
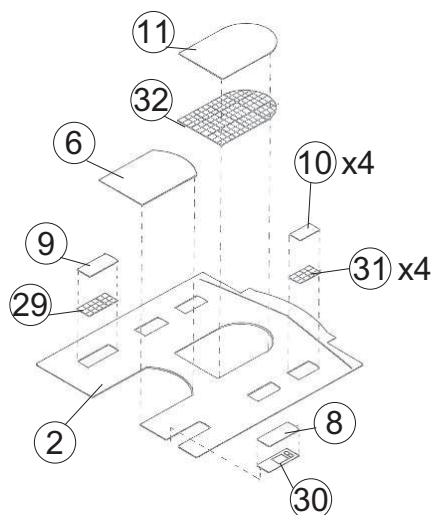
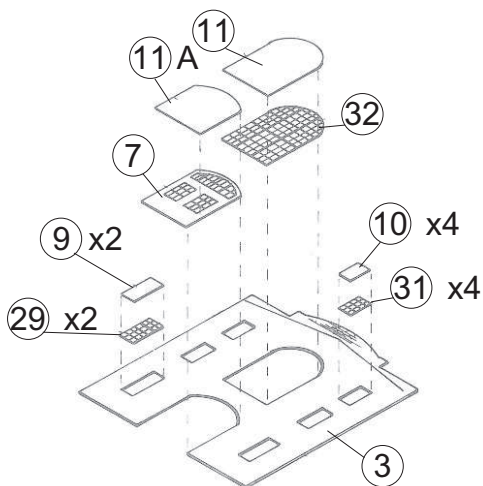

3. Glue I-beams (5) to the inside of the walls (4) as illustrated (two at one end, space, then one at the other end). NOTE: I-Beam placement on the walls should be a mirror image of each other.

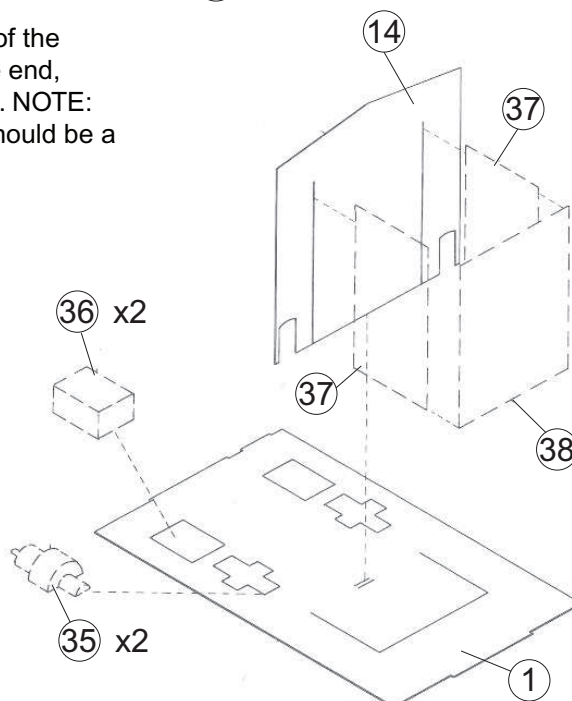

**Optional Interior Installation with Kit 933-3130:** Glue the Generators (36) and the Turbines (35) to the Floor (1) as indicated. Glue the Boiler Walls (37) & (38) together and to the Floor, following the raised placement lines. Finally, glue the Interior Fire Wall (14) to the base and back of boiler. If no interior is installed proceed to step 4.

4. Glue Walls (2, 3, 4) and Interior Fire Wall (14) to Base (1). NOTE: Girders from Overhead Crane #933-3012 (sold separately) can be added if desired, following the instructions in the crane kit.

Optional Girder from 933-3102

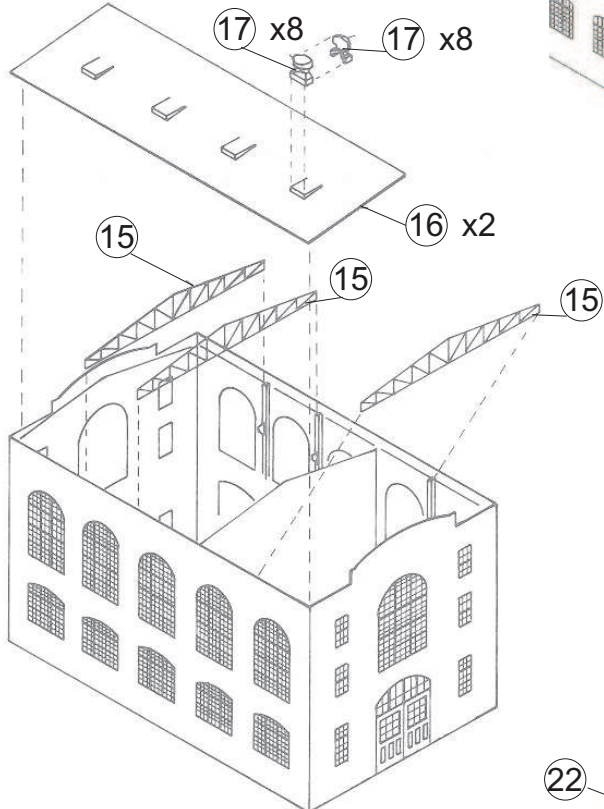
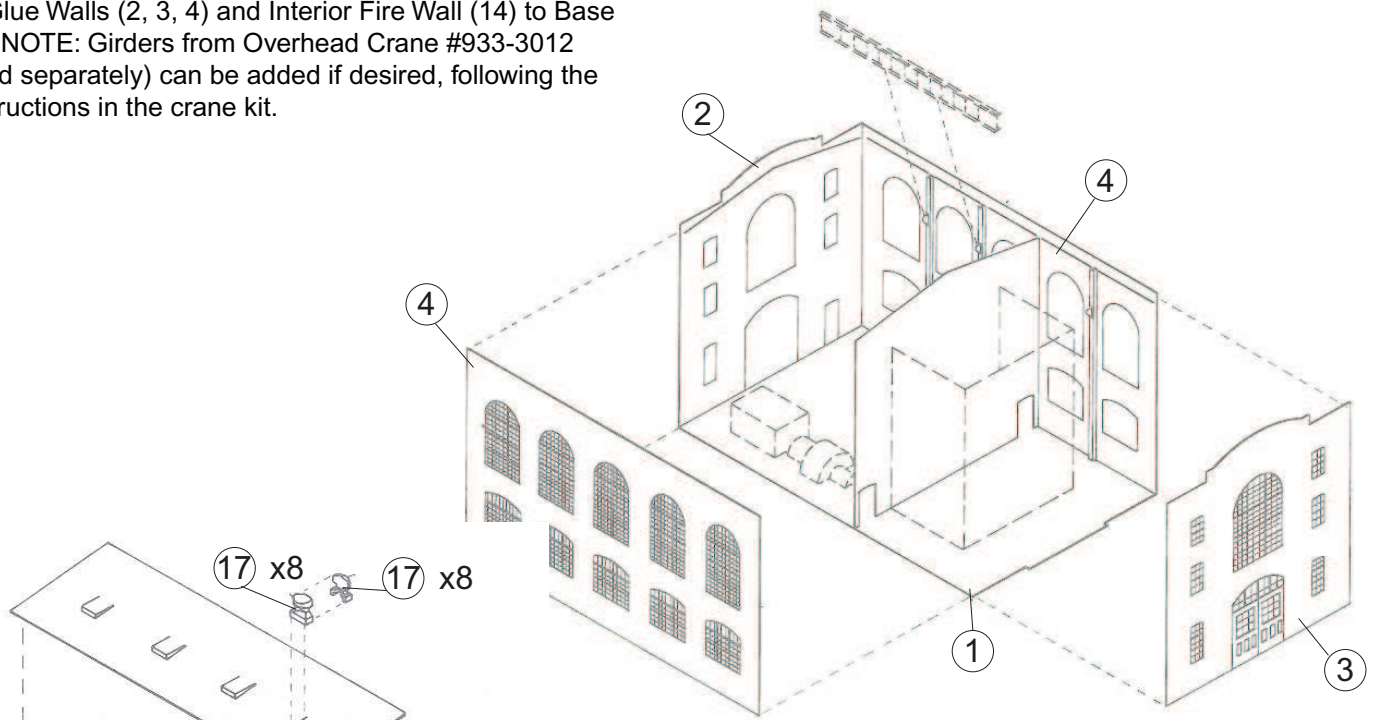

5. Glue Trusses (15) into the slots on the inside of Walls (4). Glue the Vent Halves (17) together and then to Roof (16). Then, glue roof pieces in place.

6. Glue Chimney to Base (20). Glue the Smoke Duct Sides (23, 24, 39) then to Base (20). Glue Cap (22) to top of Chimney

Assemble the coal delivery hopper by gluing the Sides (26) to the Bottom angles (27). Glue the Bottom (25) in place. Glue the Top Grate (28) to assembly.

NOTE: This hopper would be mounted under the track so that hopper cars could dump their coal through the grate. To model this, first cut the ties away from a piece of track the length of the grate. Then, place the track rail within the grooves on the top of the grate. For a stronger assembly, glue the rails to the grate with a small drop of slow setting CA or GOO®.

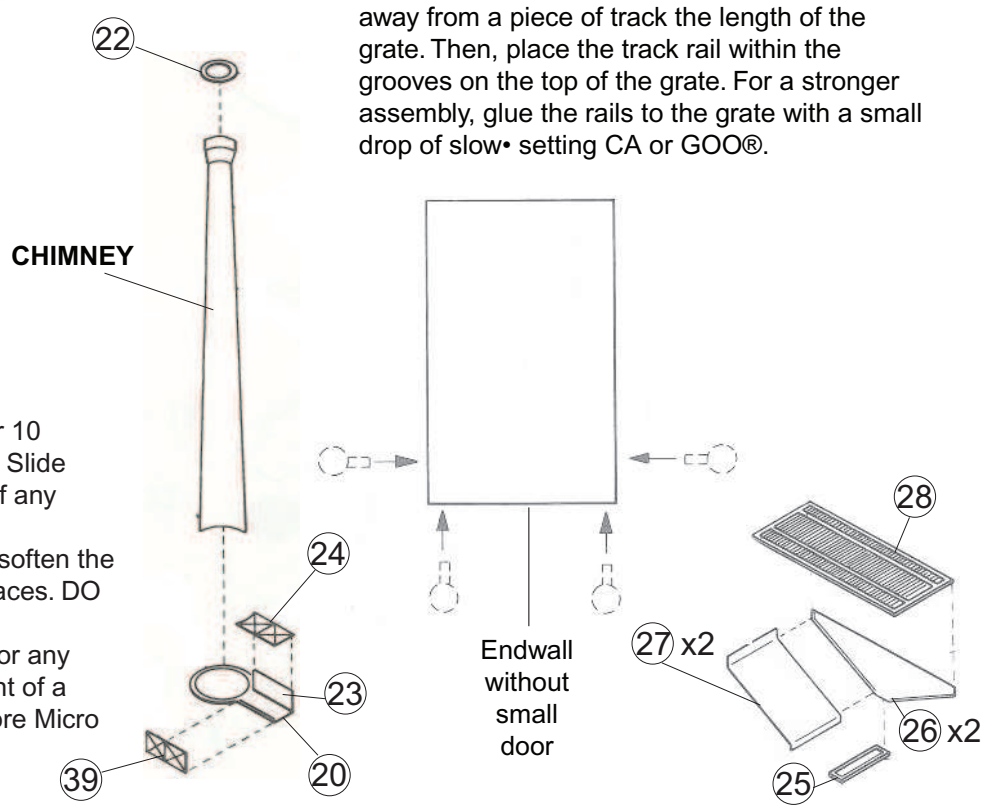

### DECALING

1. After cutting out the decal, dip in water for 10 seconds, remove and let stand for 1 minute. Slide decal onto surface, position and then blot off any excess water.
2. Lightly brush Micro Sol® on top. This will soften the decal allowing it to conform to irregular surfaces. DO NOT TOUCH DECAL while wet!
3. When the decal is thoroughly dry, check for any trapped air bubbles. Prick them with the point of a small pin or hobby knife blade and apply more Micro Sol®.