



HO Structure Kit **VILLAGE PIZZA** 933-3469

Thanks for purchasing this Cornerstone Series® kit. Please read all instructions and study the drawings before starting — directions for the interior graphics are printed directly on that sheet. All parts are styrene plastic, so use compatible glue. If you wish to decorate your model, use paints for plastic models. With appropriate details and signs, your finished model fits almost any era.

Like most foods, pizza has a long history. Today's crust is a distant cousin to flatbreads made with flour, water and herbs baked in Mediterranean and Middle Eastern regions since ancient times. Mozzarella Cheese came next when domesticated water buffalo arrived from India. And tomatoes, first thought to be poisonous, were commonly added to pizza made in the Naples area by the 1700s. Cheap and easy to make, it was a staple food for the poor, but soon became popular with people in all walks of life. Pizza arrived in America with the first Italian immigrants, but was virtually unknown outside of large cities. That changed during WWII when American GIs serving in Italy who tired of bland C and K rations discovered small pizzerias across the country. Back home, demand for pizza skyrocketed in the 1950s and pizzerias sprang up from coast to coast. As one of America's favorite snacks — we consume about 350 slices every second — pizzerias like this can be found all over the country.

For more Cornerstone Series® kits as well as additional details to complete your scene, see your hobby shop, check out the latest Walthers HO Model Railroad Reference Book and our Website at waltherscornerstone.com.

1. Glue Window and Door Frames to each Wall as shown. Glue Window Glass in place as shown. Interior windows can be added at this time (refer to printed interior sheet)

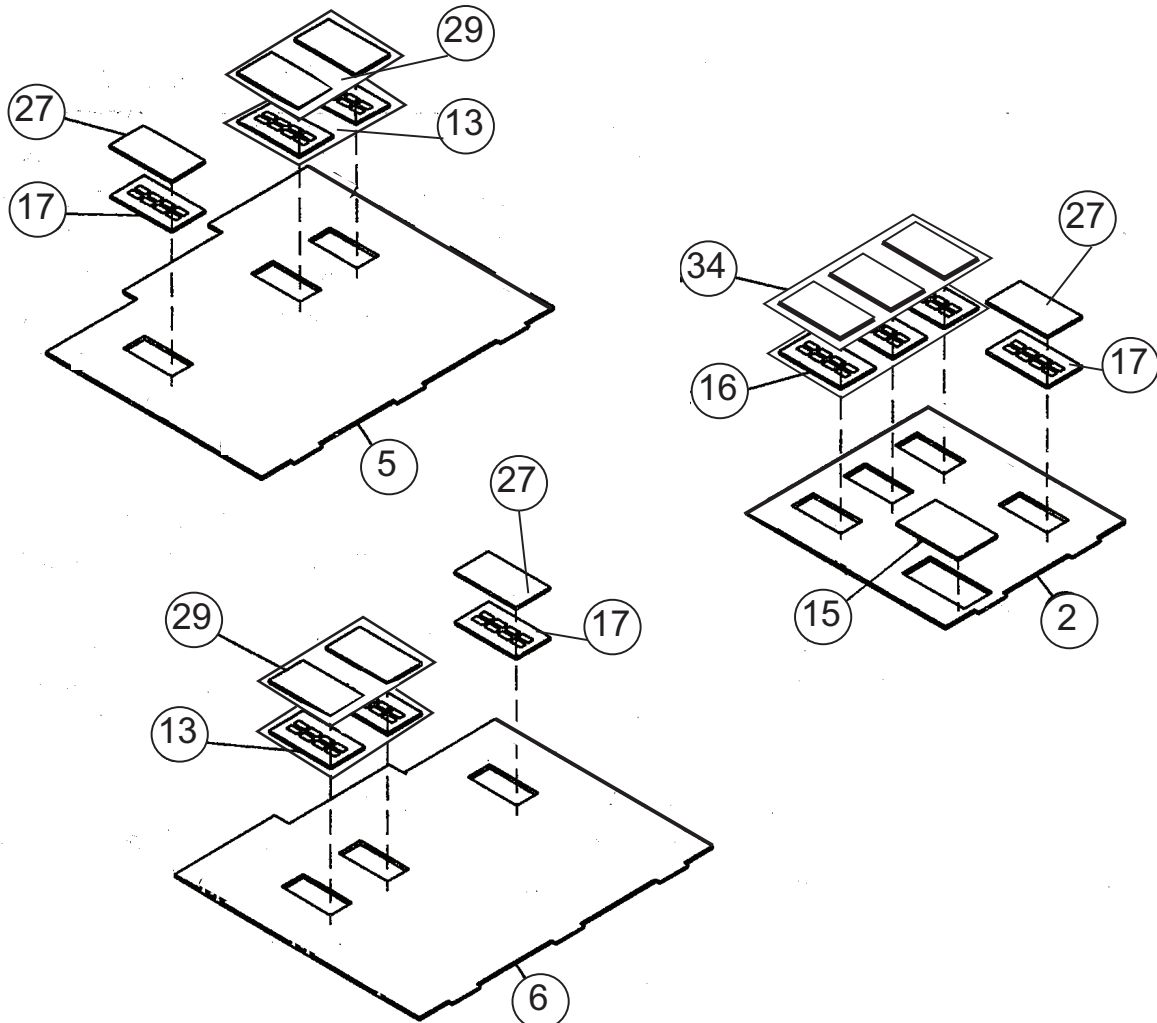

2. Glue the Front Window Frames (14) onto Front Wall (4). Glue the Window Glass (33) onto the back of the Window Frames (14). Then glue Cornice (7) to Front Wall (4).

3. Glue the Storefront Window Glass (31) to Store Front Frame (11).

4. Glue the Store Front Assembly (11) onto the Front Wall (4).

6. Glue the 4 walls together, then glue the Roof (9) to the walls.

7. Glue the 2 Chimney Halves (8) together and then glue on the Cap (10). Glue the assembled chimney into the Roof (9).

8. The finished structure can be set on the Base (1) if you wish to add interiors details at a later time, or glued in place to complete construction.

NOTE: If you plan to use your model with Walthers Street System, trim the front sidewalk from the Base (1).

NOTE: Village Pizza uses Sign #25.

